

## CARTRIDGE BILGE & AERATOR PUMP ASSEMBLY

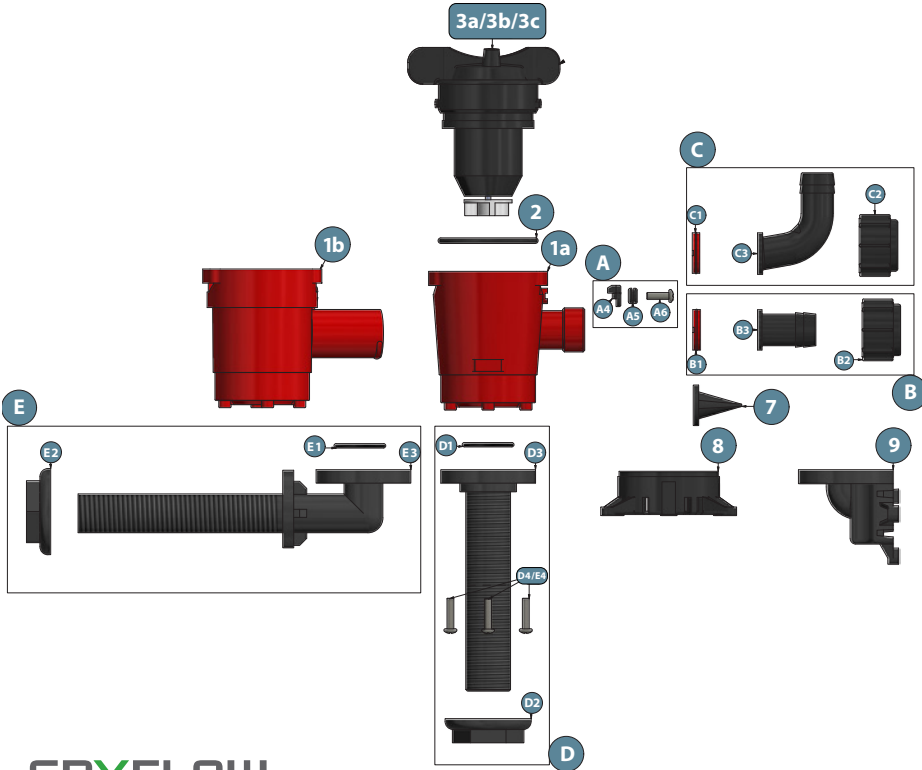

### PARTS LIST

ITEM	QTY	PART NUMBER	DESCRIPTION
*	*	NSS - Not Sold Separately	
1a	1	NSS	500/750/1000 GPH Cartridge Housing
1b	1	NSS	1250 GPH Cartridge Housing
2	1	50512PK	Motor Cartridge Housing O-Ring
3a	1	28552	500 GPH Cartridge Motor
3b	1	28572	750 GPH Cartridge Motor
3c	1	JP-42522	1000/1250 GPH Cartridge Motor
A	1	54230PK	Locking Tab Assembly
A4	1	NSS	Locking Tab
A5	1	NSS	Grommet
A6	1	NSS	Screw
B	1	92105	Straight Duraport Assembly
C	1	92205	90 Degree Duraport Assembly
B1/C1	1	NSS	Duraport Grommet
B2/C2	1	NSS	3/4in Duraport Nut
B3	1	NSS	3/4in Duraport Straight
C3	1	NSS	3/4in Duraport 90 Degree
7	1	50533PK	Nitrile Check Valve
8	1	54235PK	Bilge Basket Assembly
9	1	54270PK	LowBoy Bilge Basket Assembly
D	1	54234PK	Straight Aerator Thru-Hull Assembly
E	1	54236PK	90 Degree Aerator Thru-Hull Assembly
D1/E1	1	NSS	Aerator O-Ring Seal
D2/E2	1	54033PK	Aerator Thru-Hull Nut
D3	1	NSS	Aerator Thru-Hull, Straight
E3	1	NSS	Aerator Thru-Hull, 90 Degree
D4/E4	4/3	NSS	Aerator Thru-Hull Screws